

# Easy-S

Sliding doors

STAINO & STAINO  
Doors and systems for interiors

# INDEX

Introduction to Easy-S doors

04

External sliding Easy-s doors

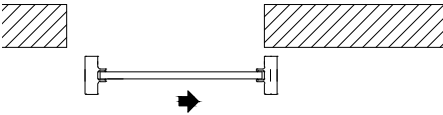

06

Internal sliding Easy-s doors

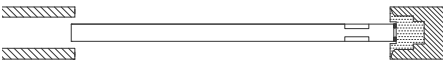

08

Easy-s pivot doors

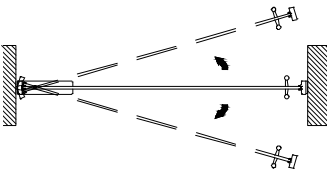

10

White milk laminated glass

12

Fumé reflective glasses

14

Photos of our customers

16-29

30-37

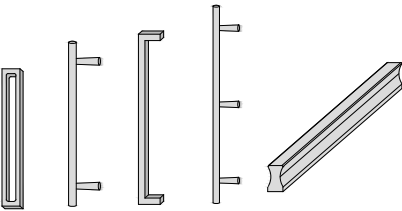

38-41

Data sheets | doors

sliding doors  
sliding openings  
pivot doors

Data sheets | handles

rectangular handles MA17  
handles for sliding doors MA07  
optional handles

42-45

Dseigns for glazed glasses

46-47

Dseigns for varnished glasses

48-49

Aluminium profile&glasses finishes

50-51

Varnished glasses&mirrors finishes

# DOOR

## easy-s

**THE EASY-S SLIDING PANEL SYSTEM** allows the subdivision of interior spaces with doors characterized by a particularly slender perimeter profile, in line with the most rigorous and contemporary architectural projects.

The Easy-s design was developed around two primary needs: the reduced section of the profile, which amplifies the feeling of openness of the spaces and responds to the aesthetic needs of the designers, and the commercial competitiveness, obtained thanks to a particularly rapid manufacturing Interesting.

Thanks to the particular design of the profile, Easy-S offers a very light image, resulting in a discreet and elegant presence. The work times for the realization of the doors have been shortened thanks to particular project specifications, with positive consequences in terms of costs and speed of delivery that make Easy-S the entry-level collection of the STAINO & STAINO catalog, a successful mix of design and technical solutions for an attractive product that meets the quality standards of our company. As with the other company collections, the Easy-S system can also be customized in the finishes of the profiles and glass.

EASY-S  
PA03 | clear fumé glass CR05 | MA18



EASY-S  
PA02 | clear fumé glass CR05 | MA17

# EASY-S SLIDING DOORS

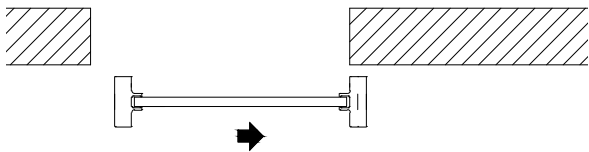

The Easy-S door is made to measure to the millimeter, both in height and in width. The customer can choose from a wide range of finishes for both profile and glass. The sliding tracks can be classic or recessed (as in the photo).

It is possible to communicate with our technicians to evaluate all the design opportunities and create the solution that best suits the customer's needs.





# SLIDING EASY-S FOR BOXES FLUSH TO THE WALL

The Easy-S sliding door can be prepared for insertion into sliding boxes that do not require the assembly of the casing, upon customer request, the company can provide both the door and the box.

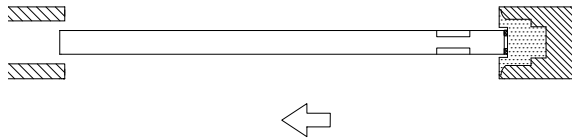

# EASY-S PIVOT DOORS

The Easy-s door is also available in the pivot version, with integrated soft closing system and stop at  $0 \pm 90^\circ$ , always made to measure both in width and height.

There are decorative crosspieces made with extruded aluminum profiles with a particularly thin section.

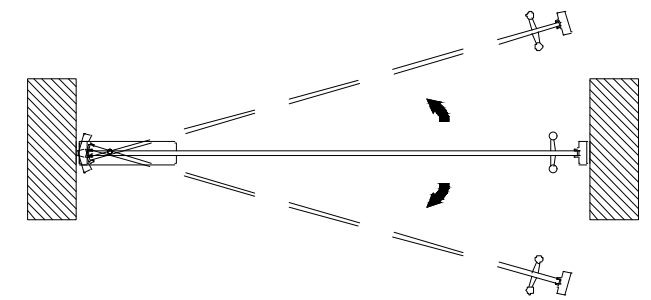

EASY-S  
PA03 | clear fumé glass CR05 | MA17 | crosspieces EIGHT





EASY-S  
PA02 | white milk glass CR03 | MA17

## WHITE MILK LAMINATED GLASS

The milky white opal glass guarantees privacy without preventing the diffusion of light.

Particularly easy to clean, it has both glossy sides as the opal surface remains inside the two slabs, joined by the layering process.

It guarantees maximum safety because, in the event of breakage, the glass fragments with a cobweb effect that prevents the glass fragments from falling.





# SMOKED REFLECTIVE GLASS

The reflective glass varies the level of transparency according to the light present, see photos.

For example, when the glass is illuminated only from the outside, the surface appears as reflective / mirrored (photos 1 and 2).



3

However, when light is present on the opposite side, the door changes appearance, becoming almost completely transparent (picture 3 and 4).

THE LEVEL OF TRANSPAR-  
ENCY VARIES ACCORDING TO  
THE **DIFFERENCE IN LIGHT OF**  
THE ENVIRONMENTS THAT  
THE DOOR DIVIDES.





# PHOTOS OF OUR COSTUMERS

Some photos taken by our customers.

EASY-S  
PA03 | clear glass CR01 | MA 17 | crosspieces THREE

## DESIGN APARTMENT

A large Easy-S sliding door with a special height of 360 cm, aluminum in matt black finish and laminated transparent glass. MA 17 handle, with the same finish as the doors. The horizontal aluminum cross bars measure only 12 x 12 mm. Apartment designed by the architects Mariella Corsi and Laura Bianchi of ARCHBCSTUDIO ([www.archbcstudio.com](http://www.archbcstudio.com))



### SEE THE PROJECT

click on our link, you will be redirected to the [stainoestaino.it](http://stainoestaino.it) site





# CUSTOM DESIGNS

The Easy-S closures can be composed of fixed and opening doors, according to the customer's project. In the photos: Easy-S sliding and fixed side doors with h 20 mm crosspieces arranged on a design by Architects Lorenzo Cantini and Valentina Miccicci of Identity Design ([www.idenitydesign-group.com](http://www.idenitydesign-group.com))



## SEE THE PROJECT

click on our link, you will be redirected to the [stainoestaino.it](http://stainoestaino.it) site

EASY-S  
PA03 | clear glass CR01 | MA17 | crosspieces h20mm custom





# CITY HOME DESIGN

A historic town house, where the generous volumes are the only reminder of another era. The complete renovation of the building was designed to make this classic home contemporary.

For the division of the convivial areas, sliding doors from the Easy-S collection were chosen with perimeter profiles and handles in matt black lacquered aluminum, transparent laminated glass in a smoked finish.

Drag sliding system with four tracks, trolleys with amortized closure.



## SEE THE PROJECT

click on our link, you will be redirected to the [stainoestaino.it](https://stainoestaino.it) site



EASY-S  
PA03 | clear glass CR01 | MA17



# HABITAT DESIGN

Easy-S door with four sliding doors, the extruded aluminum profile is opaque black while a transparent glass was chosen for the door. MA 17 handle, with the same finish as the doors.

At Habitat Immobiliare, Prato, P.zza Mercatale



## SEE THE PROJECT

click on our link, you will be redirected to the [stainoestaino.it](https://stainoestaino.it) site





# EASY-S LIVING

In this project, closures were made with pivot doors from the EASY-S collection, profiles in matt black finish and transparent laminated glass in smoked finish, the decorative crosspieces arranged according to the customer's design, are made with horizontal profiles of 20 mm and 10 mm vertical profiles, the MA-17 handles specific for the Easy-S pivot doors are made from solid aluminum and have a finish coordinated with the perimeter profiles.

The Easy-S pivot door that separates the sleeping area from the living room is equipped with optional profiles with telescopic brushes, these thin profiles designed specifically for the Easy-S pivot doors, reduce the contact between the door and the wall, and also allow compensate for the thickness of the floor skirting.

## SEE THE PROJECT

click on our link, you will be redirected to the [stainoestaino.it](https://stainoestaino.it) site



# SOFT CLOSE CLOSURE

The soft close system slows the door down during the closing phase and gently stops the door in the 0 ° position, while opening a stop is integrated that allows the door to stop just beyond 90 °. Both the 90 ° stop and the slowdown of the door work in both opening directions.

The soft close integrated system is standard on Easy-S pivot doors, no need for floor or ceiling cut-outs because all the operating components are integrated into the door profiles.

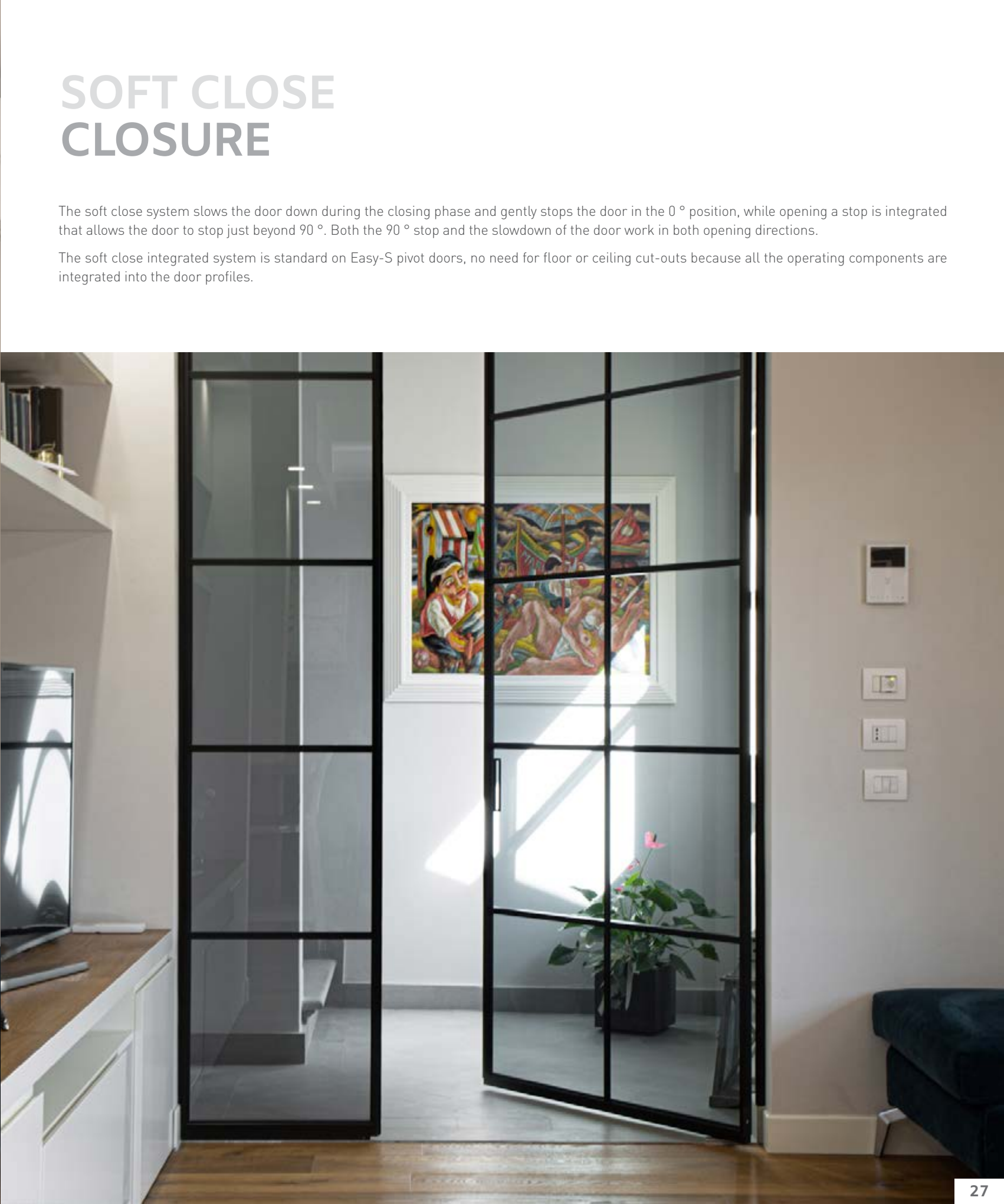





**EASY-S**  
**PA03** | clear fumé glass **CR05** | **MA 17** | crosspieces **THREE**



#### MA17 handle

The MA17 handle, standard on the Easy-S door, is made from solid aluminum and painted in a finish coordinated with the door profiles. In the photo, an optional iron gray material finish.



#### Wall uprights detail

With the optional wall uprights, a better closure is obtained between the door and the wall, even in the presence of skirting boards (as in the photo). The best insulation is especially appreciated in the kitchen.

## A GREEN SOUL



### SEE THE PROJECT

click on our link, you will be redirected to the [stainoestaino.it](https://stainoestaino.it) site

Easy-S sliding doors are made exclusively of aluminum and glass, eco-sustainable materials par excellence.

During the production phases, all processing waste is entirely recovered to be recycled. In fact, the production of Easy-S doors does not generate any waste. This feature combined with the very long life of all the materials used makes the Easy-S product a reference in Green building projects.

Project by Arch. Letizia Antonia Lerro specialist in Bio-building and Geobiology ([letizia.lerro@gmail.com](mailto:letizia.lerro@gmail.com))



# DATA SHEETS

## SLIDING EASY-S

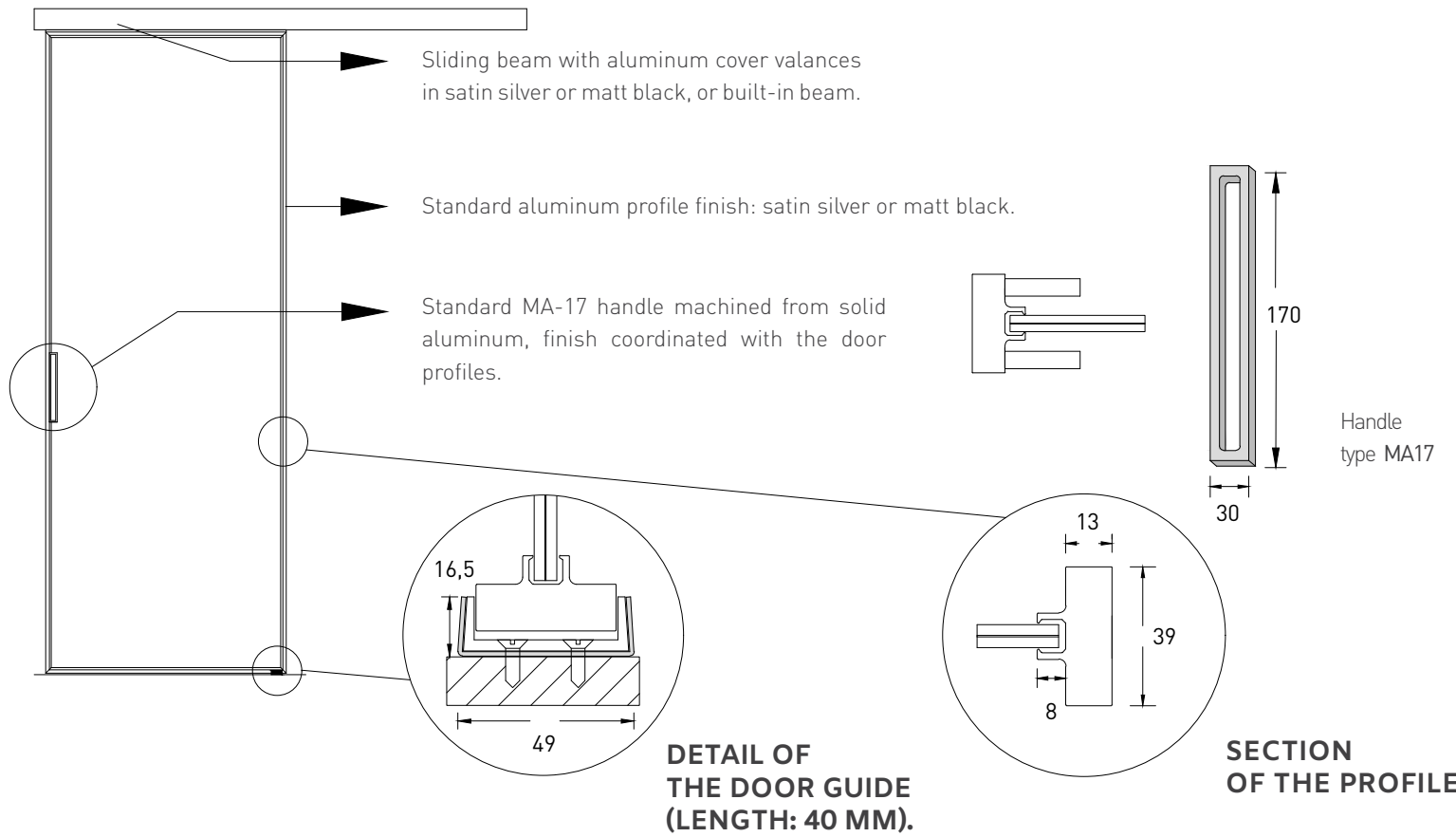

## SLIDING OPENINGS\*

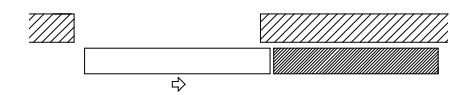

Sliding door with single rail, wall or ceiling attachment.  
Also available in built-in version.

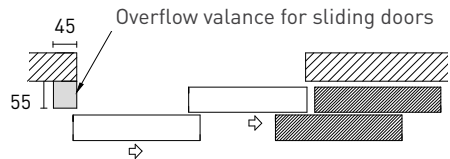

Double-panel door, two-way sliding beam with ceiling attachment. Also available in built-in version.

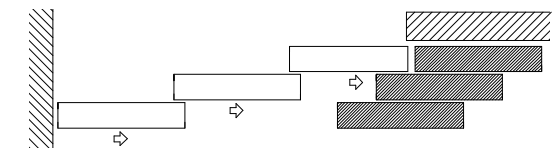

Three-panel door, three-way sliding beam with ceiling attachment. Also available in built-in version.

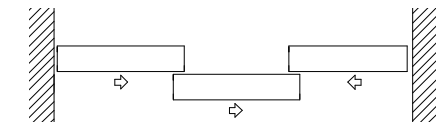

Three-panel door with two-way sliding beam with ceiling attachment. Also available in built-in version.



Four-panel door, two-way sliding beam with ceiling attachment. Also available in built-in version.

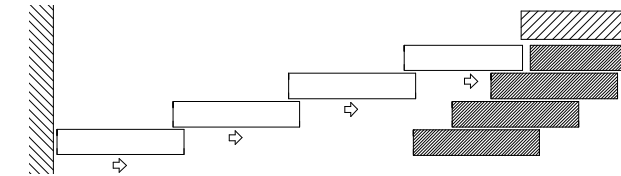

Four-panel door, four-way sliding beam with ceiling attachment. Also available in built-in version.

Beams with valance

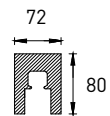

Adjustable recessed beams

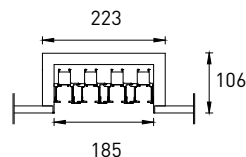
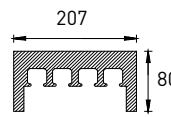
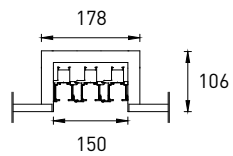
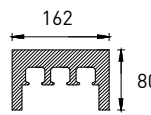
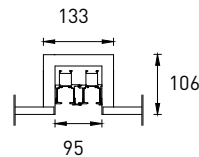
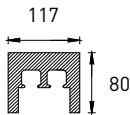
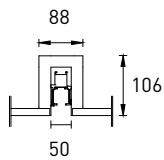

\*examples of sliding openings based on the number of doors. It is possible, on request, to create other types of opening.



WALL PROFILE FOR AIR REDUCTION:

A 12 x 12 mm section profile can be installed on the wall to reduce the air between the door and the wall.

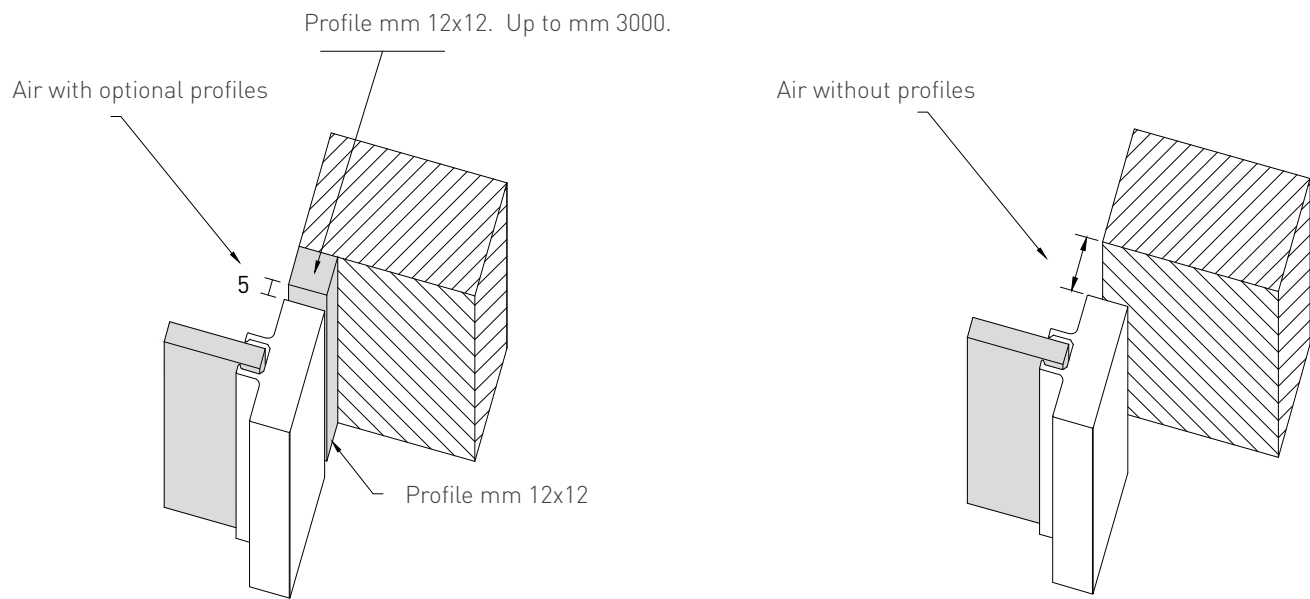

WALL UPRIGHT :

Optional wall stop upright, includes 10x10mm check profile ad-ded to the door

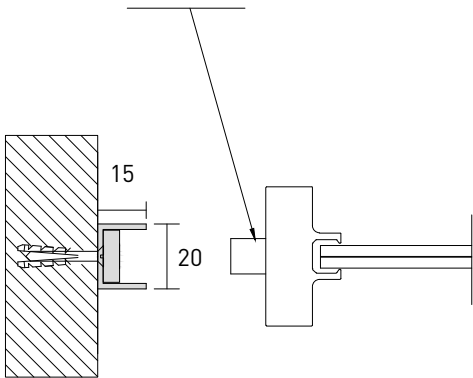

Both the upright against the wall and the striker profile are made of aluminum coordinated with the door.

OPTIONAL FLOOR WHEEL:

The floor wheel has the purpose of increasing the sta-bility of the door, it must only be used in the presence of smooth floors without joints, such as parquet or resin.

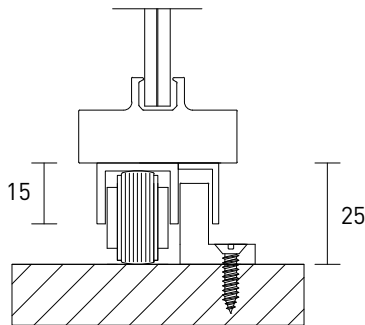

CENTRAL CLOSING UPRIGHT :

Central closing upright for double-door, consisting of a 10x10mm check profile on each door

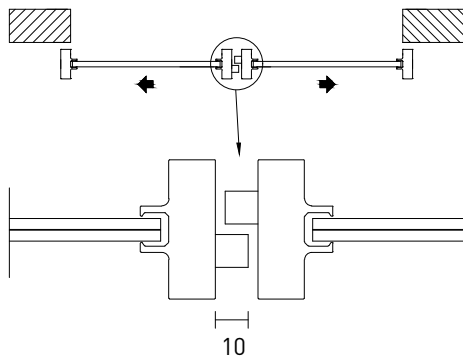

The central meeting upright allows to eliminate the light between the doors even in the case of out of plumb.

ACCESSORIES FOR SLIDING DOORS:

The drag kit includes the optional floor wheel.

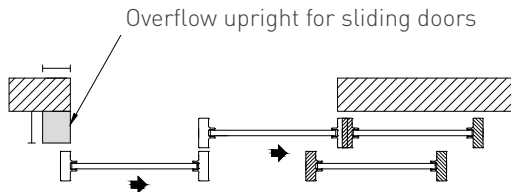

SPECIAL VERSION WITH HORIZONTAL AND VERTICAL CROSSPIECES:

The crosspieces dedicated to the Easy-S collection have a cross section of 12 x 12 mm horizontally and 10 x 8 mm vertically, they are positioned on both sides of the glass. The finish of the crosspieces is coordinated with the perimeter profiles of the door. Crossbars are not available for mirror doors. The prices shown refer only to the crosspieces, positioned as shown in the drawings (Three, Four, Six, Seven).

For any custom compositions ask for feasibility and prices to: [commerciale@stainoestaino.it](mailto:commerciale@stainoestaino.it).

THREE VERSION

12 mm horizontal crossbars evenly spaced apart.

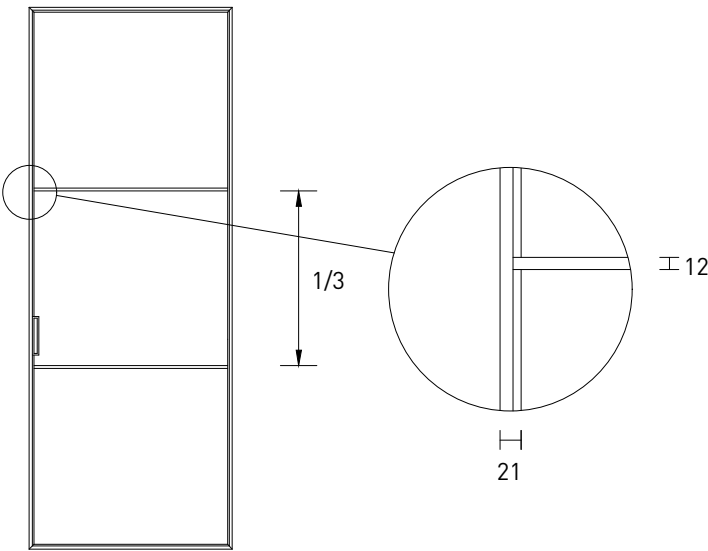

FOUR VERSION

12 mm horizontal crosspieces and 10 mm central vertical crosspiece. The crossbars are positioned according to the size of the door with the following proportions.

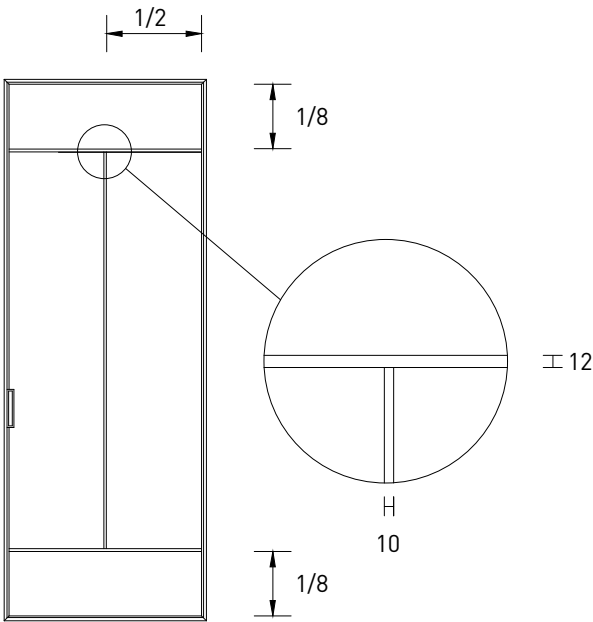

SIX VERSION

12 mm horizontal crosspieces and 10 mm central vertical cross-piece. The crossbars are spaced evenly from each other.

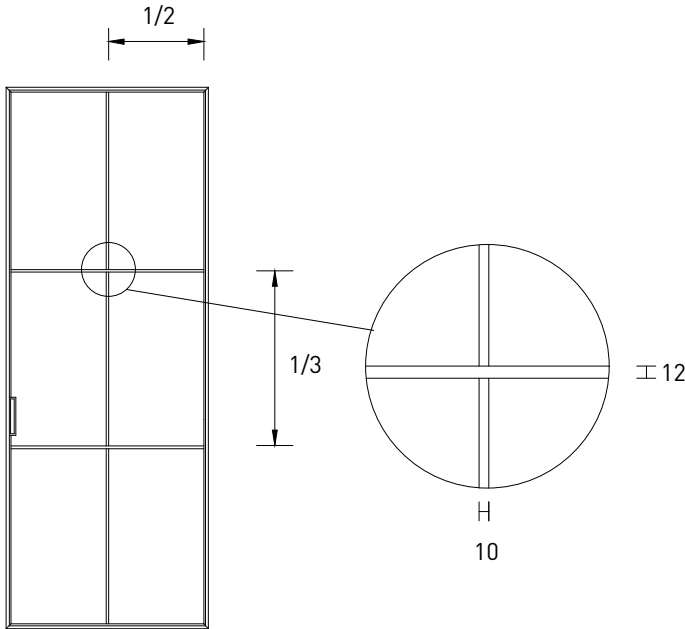

SEVEN VERSION

12 mm horizontal crosspieces and 10 mm vertical crosspieces. The crossbars are positioned according to the size of the door with the following proportions.

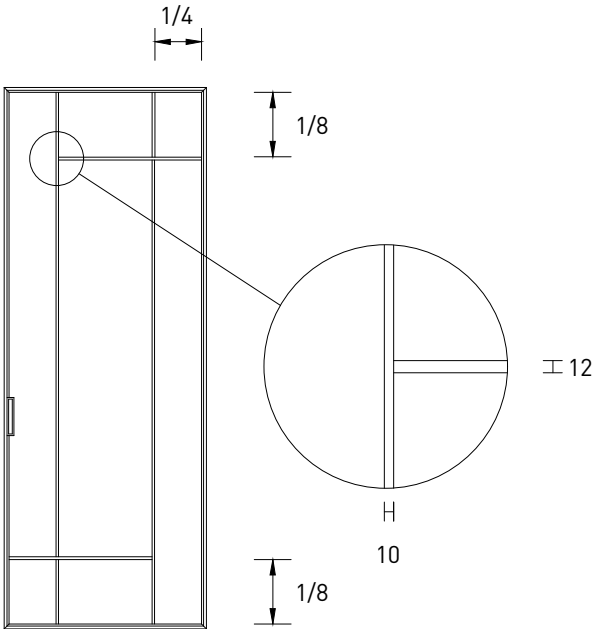

# PIVOT EASY-S

The Easy-S pivot door that separates the sleeping area from the living room is equipped with optional profiles with telescopic brushes, these thin profiles designed specifically for the Easy-S pivot doors, reduce the contact between the door and the wall, and also allow compensate for the thickness of the floor skirting.

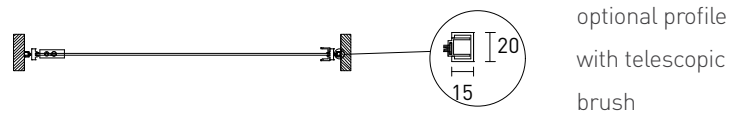
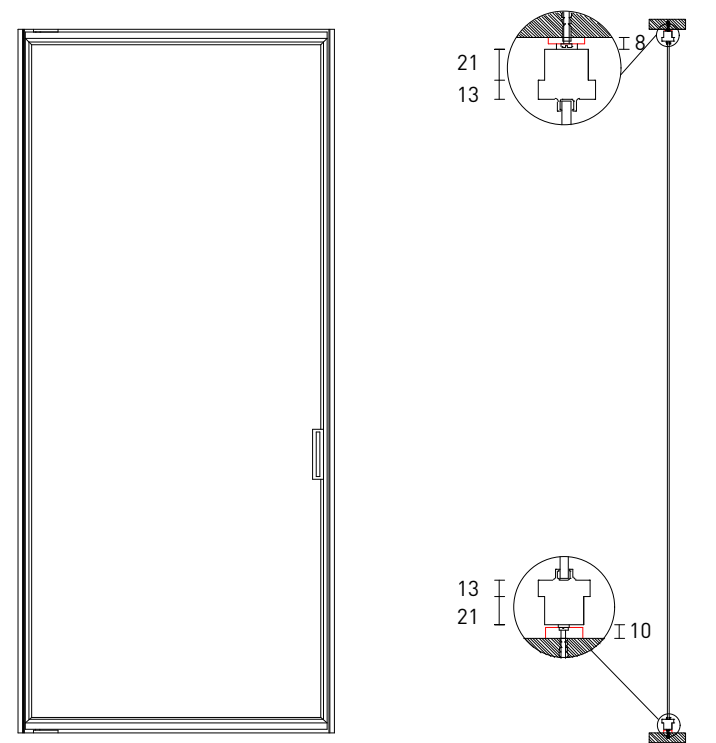

### OPENING DETAIL

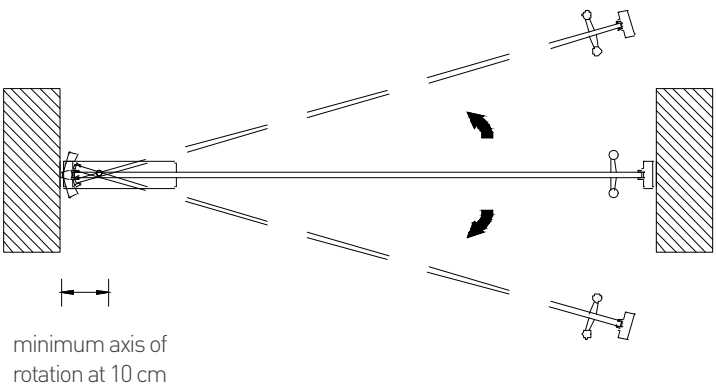

Custom-made door, passage opening dimensions up to cm 130 x 300 h, including lock with magnetic latch, floor drain and hardware embedded in the upper crosspiece, flush-fitting frame in satin silver aluminum for masonry walls.

### PAINTED GLASSES AND MIRRORS:

**CR:** Glass **SP:** Mirror **DV:** Painted decoration

- CR01** Laminated glass 6/7 mm
- CR03** Laminated white milk 6/7 mm
- CR05** Laminated clear fumé 6/7 mm
- CR02** Laminated neutral etched 6/7 mm
- CR09** Transparent bronze tempered 6 mm
- SP01, 02, 03** Silver/bronze/fumé mirror 1 lato coupled to a white panel on the other side

- CR06** Tempered frosted fumé 6 mm
- CR07** Tempered frosted extra white 6 mm
- CR08** Tempered frosted bronze 6 mm
- CR10** Tempered reflective fumé clear 6 mm

- DS** Laminated neutral sandblasted glass 6/7 mm
- DSC** with decoration chosen from our models

- DS** Extra white sandblasted glass 6 mm
- DSC** with decoration chosen from our models

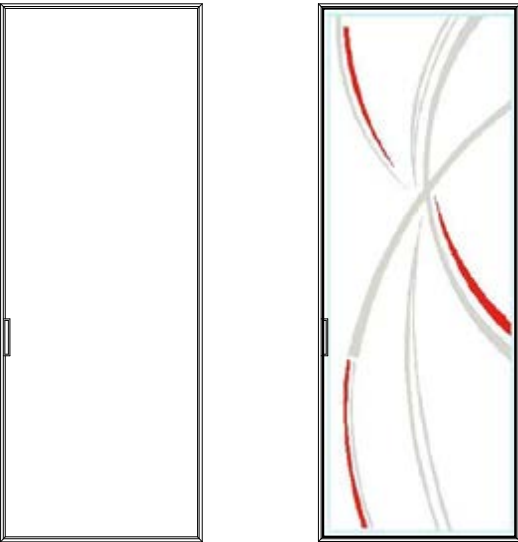

Sliding doors



Pivot doors

### OPTIONAL ALUMINUM FINISHES:

- **PA 02** white matt
- **PA 03** black matt
- **PA 05** bronze
- **PA 06** titanium
- **PA 09** corten
- **PA 10** dark bronze
- **PA 07** white oak
- **Matt Ral** sample
- Protective film for finishing wall frame

The finishes are visible on this technical sheet from page 42 to page 51.  
For customized finishes, request a quote from our technical office.



VARIATIONS FOR PIVOT DOORS:

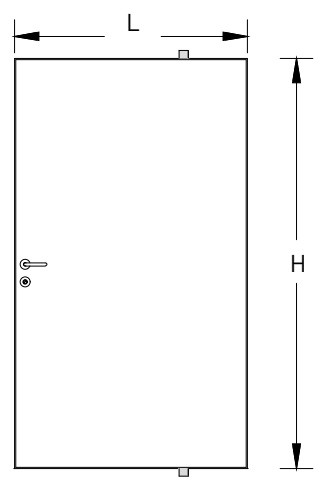

TAILORED DOORS

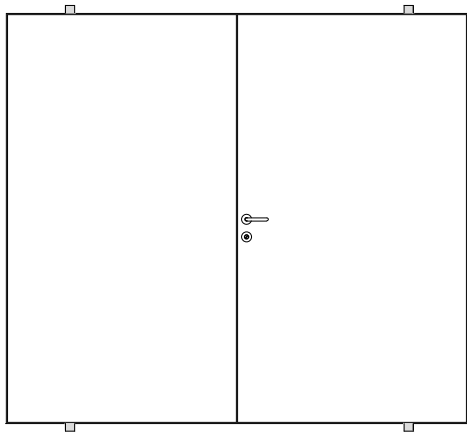

DOUBLE PIVOT DOORS

SOME EXAMPLES OF PIVOT DOORS WITH TWO SYMMETRICAL LEAVES:

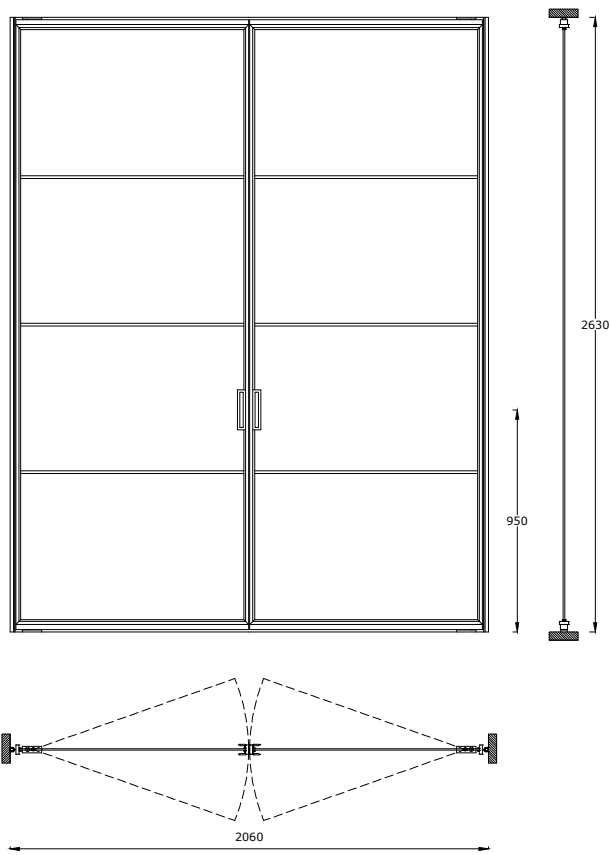
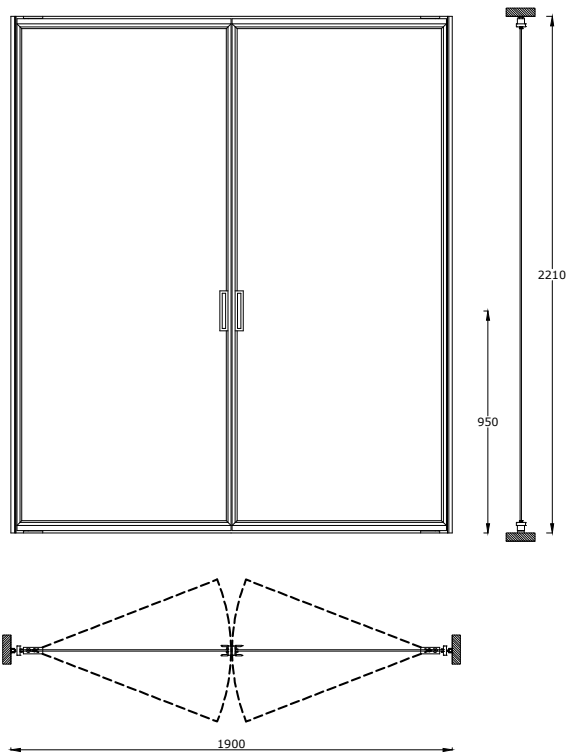

**INTEGRATED DOOR STOP AS STANDARD:**

Door closer for pivot leaf with invisible rotation pin.  
This door closer is integrated into the door, it is not mandatory to provide the upper crosspiece of the frame.  
Stop positions at 0 °, 90 ° and -90 °.  
Adjustable closing and opening cushioning.

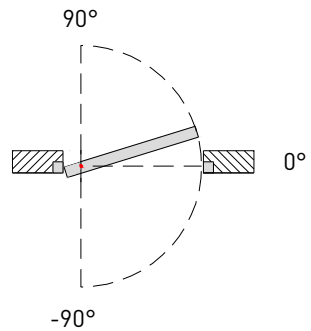



DATA  
SHEETS



handles

RECTANGULAR  
HANDLE  
MA17

The MA 17 handle is available in all the materials provided for the door. Rectangular 30 x 170 mm H.

REVOLUTION  
HANDLE

Revolution handle in billet aluminum, in a finish coordinated with the door profiles.

- solid aluminum handle, without insert
- handle with matt lacquered MDF insert
- handle with insert in glossy or satin washed glass
- privacy latch in satin or glossy chrome

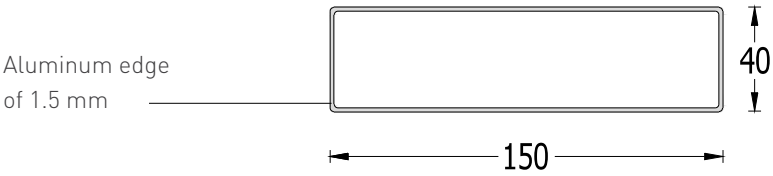
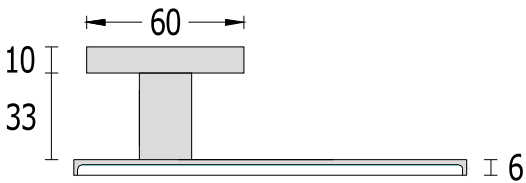
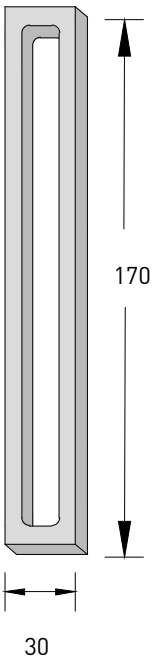
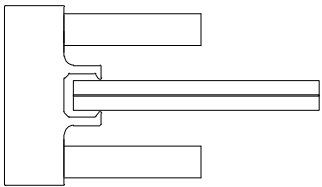
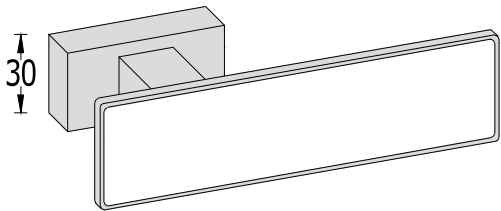



# ALUMINUM HANDLE

MA07

The handles available on this page provide for the elimination of the lock and the assembly of a magnet on the stop.

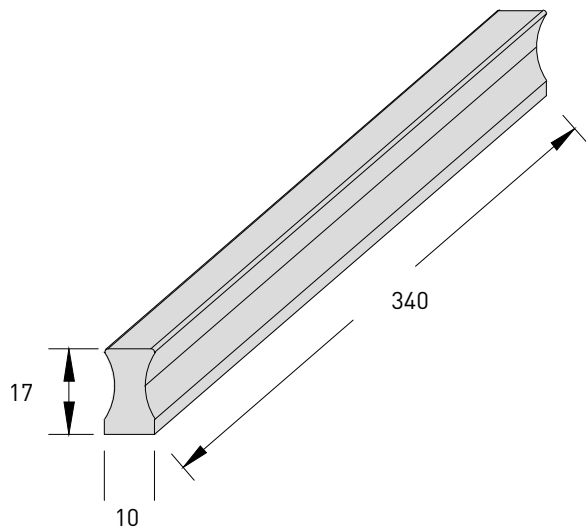
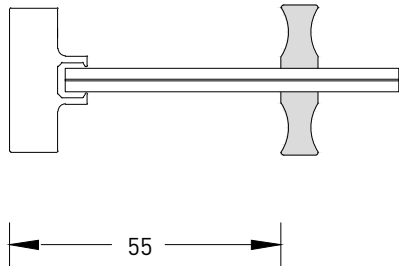

## OPTIONAL HANDLES IN VARIATION:

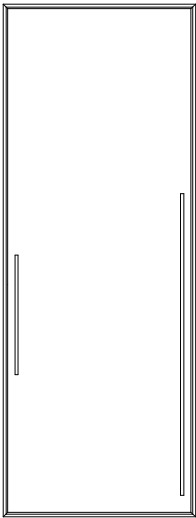

- Pair of aluminum handles H 560 mm **MA05**
- Pair of satin stainless steel handles H cm 149 **MA06**
- Pair of handles in stainless steel H 140 cm **MA04**  
(Available only on tempered glass)

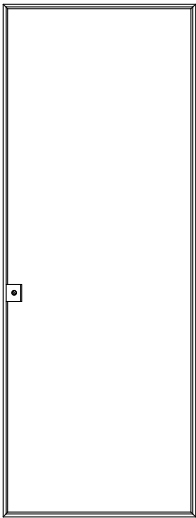
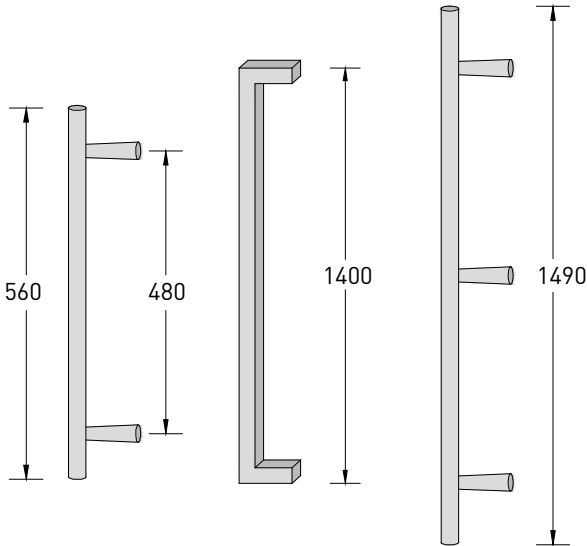
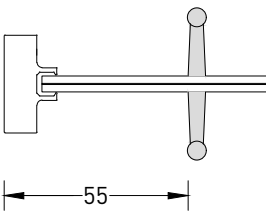

Handle machined from solid aluminum with integrated lock, includes privacy latch.  
It is supplied in a finish coordinated with the perimeter profiles of the door.  
The privacy latch is available in satin chrome, polished chrome or lacquered in matt white or black.  
Available only on tempered glass.  
The use of the wall upright for lock striker is mandatory.

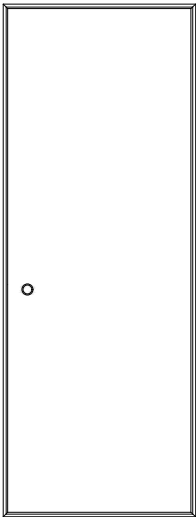
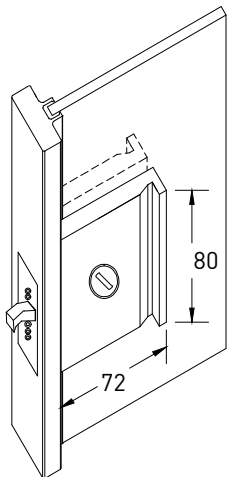
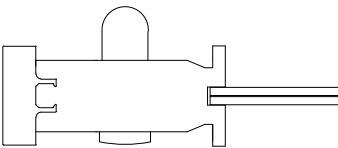

Ring with through hole for sliding ø mm 40 **MA20**  
Available only on tempered glass.

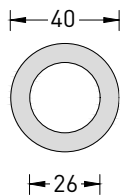
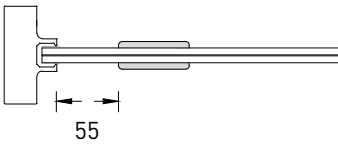



# DESIGN FOR GLAZED GLASS

It is possible to print images provided by the customer, subject to verification by our technical department.

➔ see all the decorations, follow the link to the special catalog



**DS01**  
design by  
Jacopo Cecchi



**DS06**



**DS11**

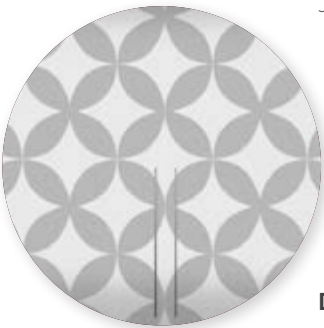

**DS02**  
design by  
Jacopo Cecchi



**DS07**  
design by  
Jacopo Cecchi



**DS12**



**DS03**  
design by  
Jacopo Cecchi

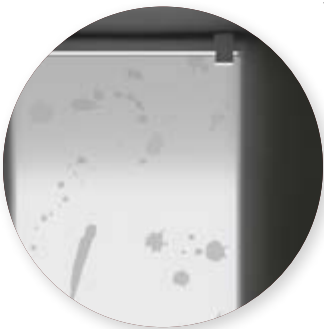

**DS08**



**DS13**



**DS04**  
design by  
Jacopo Cecchi

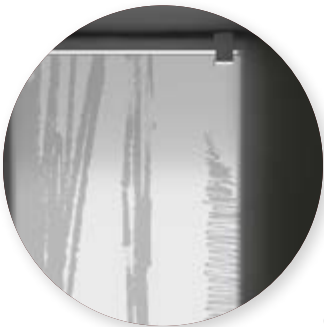

**DS09**  
design by  
Jacopo Cecchi

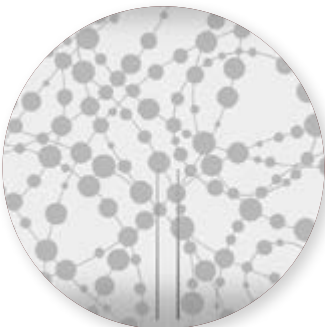

**DS14**



**DS05**



**DS10**  
design by  
Jacopo Cecchi





DS15

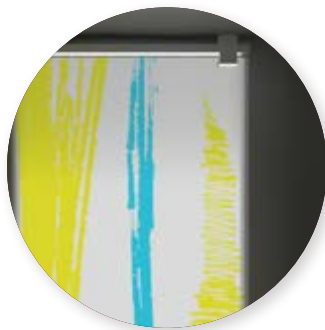

DSC01



DSC06



DSC11



DSC16

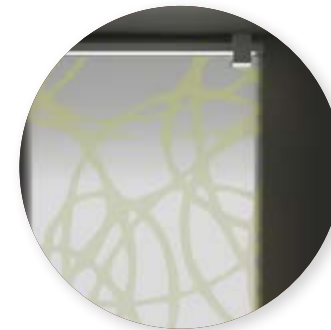

DSC21



DS16



DSC02



DSC07



DSC12



DSC17



DSC22

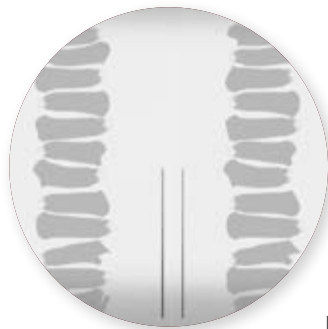

DS17



DSC03



DSC08



DSC13



DSC18



DSC23



DS18



DSC04



DSC09  
design by  
Jacopo Cecchi



DSC14



DSC19

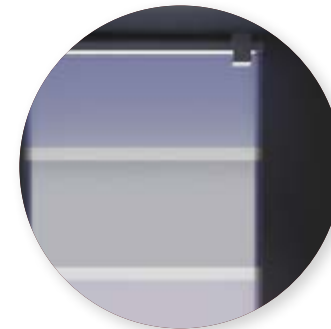

DSC24



DSC05



DSC10  
design by  
Jacopo Cecchi



DSC15



DSC20



# DESIGN FOR VARNISHED GLASS

It is possible to print images provided by the customer, subject to verification by our technical department.

→ see all the decorations, follow the link to the special catalog



DV01

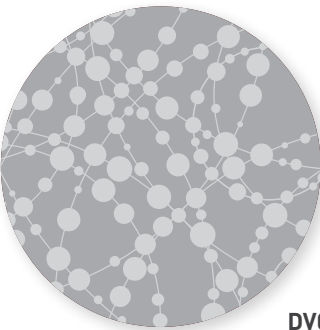

DV06



DV11

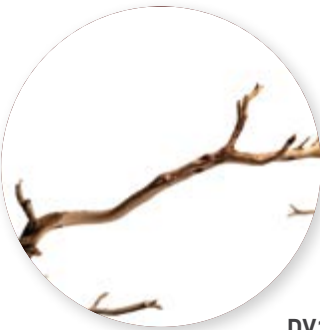

DV16



DV02



DV07



DV12



DV17



DV03

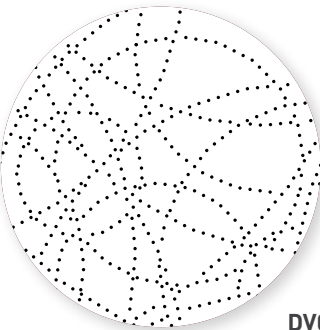

DV08



DV13



DV18



DV04



DV09



DV14



DV19



DV05



DV10



DV15



DV20



# ALUMINUM PROFILES&GLASSES FINISHES

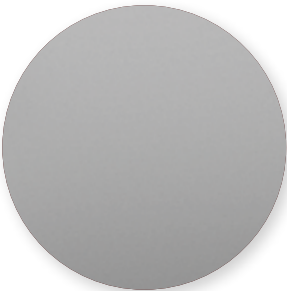

**PA01**  
Glazed silver



**PA08**  
Wenge wood

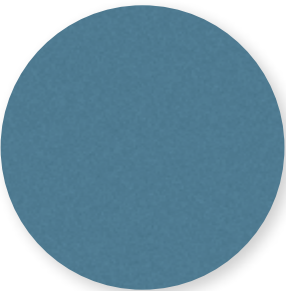

**CR04**  
Frosted blue

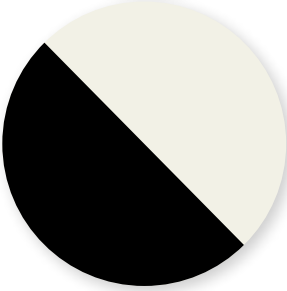

**PA02**  
Matt white  
**PA03**  
Matt black



**PA09**  
Corten

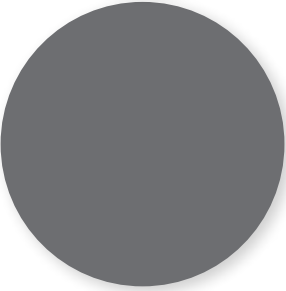

**CR05**  
Clear fumé



**PA04**  
Bright brushed silver



**PA10**  
Dark bronze  
**PA11**  
Dark copper

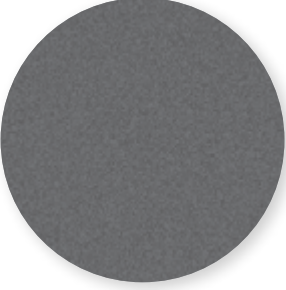

**CR06**  
Frosted fumé



**PA05**  
Bronze

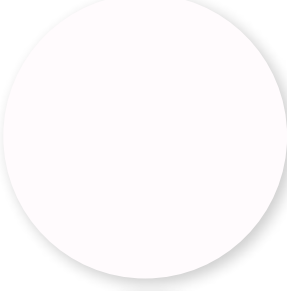

**CR01**  
Clear



**CR07**  
Frosted extra claire



**PA06**  
Titanium



**CR02**  
Frosted

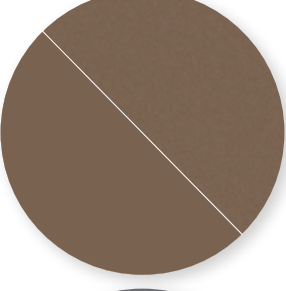

**CR08**  
Frosted bronze  
**CR09**  
Clear bronze



**PA07**  
White oak



**CR03**  
Milk white

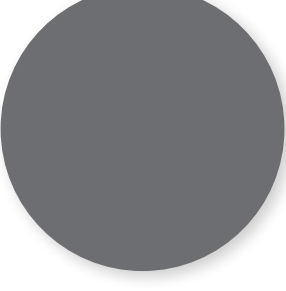

**CR10**  
Reflective fumé

\* finish available on sample

# VARNISHED GLASSES&MIRRORS FINISHES

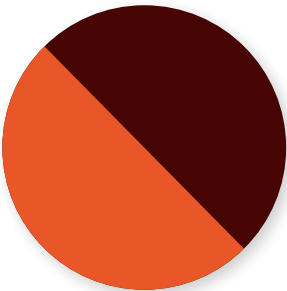

**CL01**  
Burgundry red  
**CL02**  
Orange

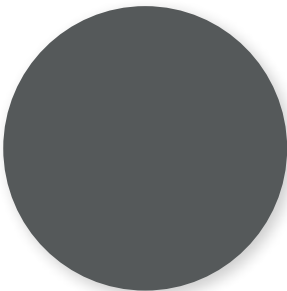

**CL13**  
British grey 7011



**SP01**  
Regular mirror

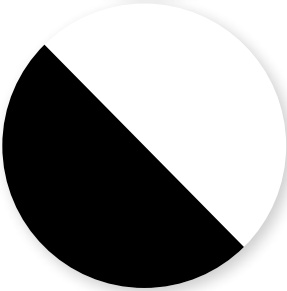

**CL03**  
Extra white  
**CL04**  
Black

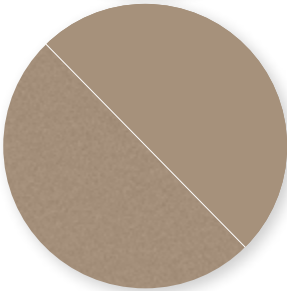

**CL14**  
Cappuccino 1019  
**CL15**  
Frosted cappuccino 1019

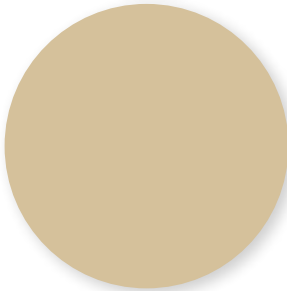

**SP02**  
Bronze mirror

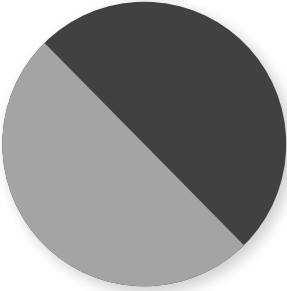

**CL05**  
Anthracite  
**CL06**  
Silver

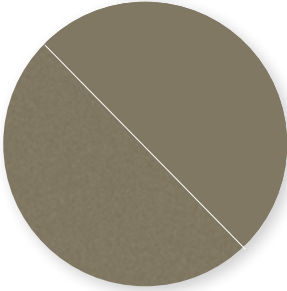

**CL16**  
Green Army 7002  
**CL17**  
Frosted green Army 7002

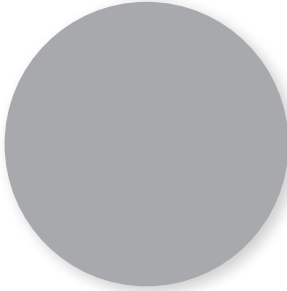

**SP03**  
Fumé mirror

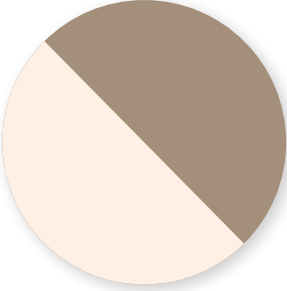

**CL07**  
Beige  
**CL08**  
Pink grey 2005

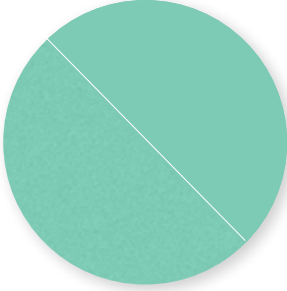

**CL18**  
Miami green 6027  
**CL19**  
Frosted Miami green 6027



**SP04**  
Glazed mirror



**CL09**  
Metropoli black  
**CL10**  
Nervuré black

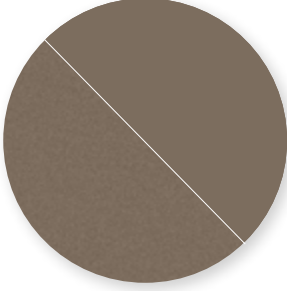

**CL20**  
Visone 7006  
**CL21**  
Frosted visone 7006



**SP05**  
Nervuré glazed silver



**CL11**  
Metallized bronze  
**CL12**  
Varnished frosted extra white



**CL22**  
J.P.Blu  
**CL23**  
Frosted J.P.Blu

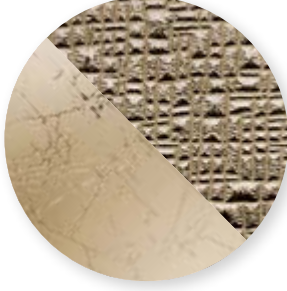

**SP06**  
Nervuré glazed bronze  
**SP08**  
Metropoli glazed bronze

\* finish available on sample



STAINO&STAINO SRL Via Danubio, 21/23/25  
59100 Prato - Italy | Tel +39 0574 69 39 38  
Fax +39 0574 69 43 55

[www.stainoestaino.com](http://www.stainoestaino.com)

[amministrazione@stainoestaino.it](mailto:amministrazione@stainoestaino.it)  
[commerciale@stainoestaino.it](mailto:commerciale@stainoestaino.it)  
[export@stainoestaino.it](mailto:export@stainoestaino.it)